

CURVE WARM DIM

Tilt

ORLUNA®

Project Reference: _____

Product Reference: _____

Luminaire Details

| | |
|--------------|----------------------------|
| Fitting Type | Tilt Downlight |
| IP Rating | IP44 |
| Warranty | 5 Years |
| Class | III |
| IP Zone | Zone 1 |
| Standards | CE, BS EN 60598 |
| Material | Aluminium ADC12 |
| Cable type | 2 Core 0.75mm ² |
| Cable Length | 300mm |
| Bezel Temp | F Rated |

Features & Benefits

- Halogen-style Warm Dimming
- TRUE BEAM
- High LOR

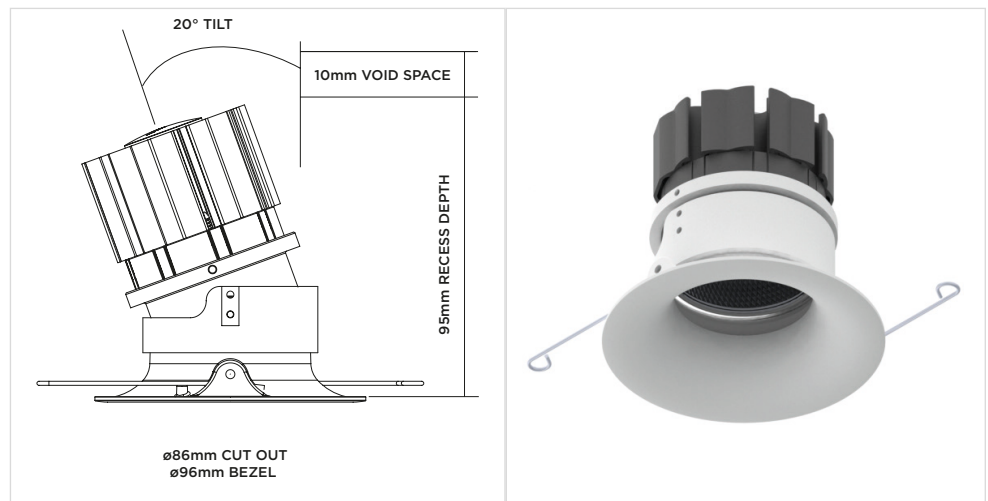

1800K - 2650K WARM DIM

| LIGHT VALUES | MEDIUM | WIDE | FLOOD |
|----------------------------------|------------------|------------|------------|
| Beam Width FWHM | 28° | 41° | 47° |
| Initial Lumens* | 901 | 901 | 901 |
| Engine Lumens* | 770 | 748 | 734 |
| <small>*(Tc 85°C, +/-7%)</small> | | | |
| Engine Lm/W | 63 | 61 | 60 |
| Luminaire Cd | 1578 | 930 | 790 |
| Binning SDCM (Hot) | 3 | | |
| DUV | 0.001 | | |
| CRI (typ)(R9) | 94 (73) | | |
| TM30 Rf Rg | Rf 92 Rg 101 | | |
| Lifetime (ambient) | L70 B5 50,000hrs | | |

For full test data, see Luminaire Photometric Reports at orluna.com/downloads

LUMINAIRE POWER

| | |
|---------------------|-------|
| Voltage | 36v |
| Drive Current | 300mA |
| Circuit Power (typ) | 12.2W |

DRIVER

| | |
|-----------------------|------------------------------------|
| Protocols | Mains Dim / DALI / 0-10V / Non-dim |
| Dim to Dark | 0.1% Lux |
| Distance from product | 20m (series wiring) |
| Emergency | Emergency packs available |

Specification Code

| | | | | | | |
|-------------|----------------|---------------|---|-------------------------------------|---|--|
| Engine type | Bezel | Colour Temp | Driver | Beam Width | Bezel Colour | IP Rating |
| WD | - CVT - | WD | M | M | - W - | F 44 E |
| | | WD / Warm Dim | M / Mains Dim D / DALI O / 0-10v X / No Driver | M / Medium W / Wide F / Flood | W / White RAL 9010 D / White RAL 9003 E / White RAL 9016 B / Black RAL 9005 C / Other RAL | F / Fire Rated 44 / IP44 J / Jigsaw E / 3hr Emergency Z / LSZH Cable |